

# PARTS MENU

## DF125GKB



# Dongfang Motor Inc

Manufacturer: Ningbo Dongfang Lingyun Vehicle Made Co.,Ltd

Please make reference to this menu when you plan to purchase the parts.  
Any difference with the real vehicle, Please take the real parts as standard.

Any modifications will not be informed ahead of time.

### 发动机 (Engine)



序	件 号	中 文 名 称	英 文 名 称	数 量	单 价	单 价
NO.	Code name	Chinese	Description	Q' ty	¥	\$
1	01010008/01010009	发动机 (1P53-3+1)	Engine(1P53-3+1)	1		
2	01030004	化油器(手动风门PZ20K)	Carburator(PZ20K)	1		

## 气缸头盖组合 (Cylinder Head Cover)

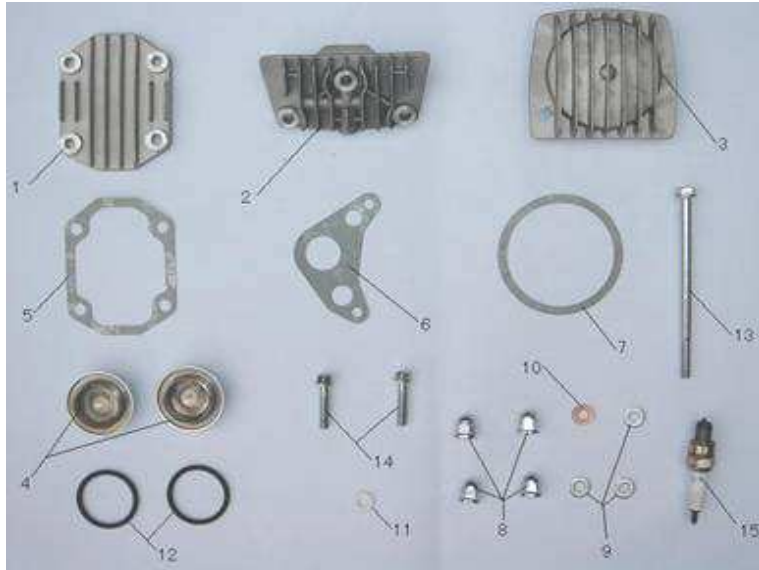

序	件号	中文名称	英文名称	数量	单价	单价
NO.	Code name	Chinese	Description	Q'ty	¥	\$
1	1010005-1P50FMG	气缸头头盖	Upper Cover, Cylinder Head	1		
2	1010030-1P50FMG	气缸头右盖	Right Cover, Cylinder Head	1		
3	1010017-1P50FMG	气缸头左盖	Left Cover, Cylinder Head	1		
4	1010021-1P50FMG	气门盖	Valve Cover	2		
5	1000031-1P50FMG	气缸头头盖纸垫	Cylinder Upper Cover Washer	1		
6	1010034-1P50FMG	气缸头右盖纸垫	Cylinder Right Cover Washer	1		
7	1010003-1P50FMG	气缸头左盖纸垫	Cylinder Left Cover Washer	1		
8	GB923-86	盖形螺母M6	Nut M6	4		
9	GB97.1-85	垫圈φ6	Washer φ6	3		
10	GB96-85	铜垫φ6	Copper Washer φ6	1		
11	GB97.1-85	垫圈φ8	Washer φ8	1		
12	GB3452.1-92	O形圈30.5×3.5	O-Ring 30.5×3.5	2		
13	GB5783-86	螺栓M6×110	Bolt M6×110	1		
14	GB5787-86	螺栓M6×20	Bolt M6×20	2		
15	1150900-1P50FMG	火花塞	Spark Plug	1		

## 气缸头组合 (CYLINDER HEAD ASSEMBLY)



序 NO.	件 号 Code name	中文名称 Chinese	英文名称 Description	数量 Q' ty	单价 ¥	单价 \$
1	1010010-1P52FMH-R	气缸头组件	Cylinder Head assemble	1		
2	1010040-1P52FMH	气缸头密封垫组件	Cylinder Head washer assemble	1		
3	1100003-1P50FMG	进气管 (030209-101)	Inlet Pipe	1		
4	1100010-1P50FMG	隔热垫	insulation Washer	1		
5	1010035-1P50FMG	双头螺栓M6×32	Double head Bolt M6×32	2		
6	GB5783-86	螺栓M6×23	Bolt M6×23	1		
7	100065-1P50FMG	返边衬套9.5	Returned Bush 9.5	1		
8	GB3452.1-92	O形密封圈27×2	O-Ring 27×2	1		
9	1100004-1P50FMG	进气管密封垫	Inlet Pipe Seal Washer	1		
10	1000026-1P50FMG	矩形密封圈11.7×9×1.5	Rectangular Ring 11.7×9×1.5	1		
11	GB5787-86	六角法兰螺栓M6×28	hexangular Flange Bolt M6×28	2		
12	GB5787-86	六角法兰螺栓M6×22	hexangular Flange Bolt M6×22	2		

## 凸轮轴、气门 (CAMSHAFT, VALVE)

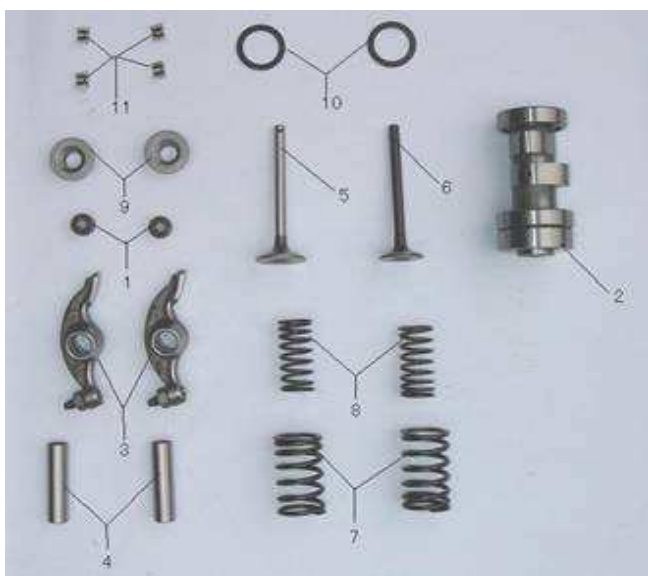

序 NO.	件号 Code name	中文名称 Chinese	英文名称 Description	数量 Q' ty	单价 ¥	单价 \$
1	1060510-1P50FMG	挡油罩组件	Warding Oil cover Assemble	2		
2	1060100-1P50FMG	凸轮轴组件	Camshaft Assemble	1		
3	1060210-1P50FMG	气门摇臂	Valve Swing Arm	2		
4	1060208-1P50FMG	气门摇臂轴	Valve Swing Arm Shaft	2		
5	1060505-1P50FMG	进气门	Come Valve	1		
6	1060506-1P50FMG	排气门	Exhaust Door	1		
7	1060504-1P50FMG	气门外弹簧	Valve Out Spring	2		
8	1060503-1P50FMG	气门内弹簧	Valve In Spring	2		
9	1060502-1P50FMG	气门弹簧座	Valve Spring Seat	2		
10	1060508-1P50FMG	气门弹簧座圈	Valve Spring Seat Ring	2		
11	1060501-1P50FMG	气门锁夹	Valve Lock Clip	4		

## 正时链条、张紧机构 (TIMING CHAIN, TRAINER)

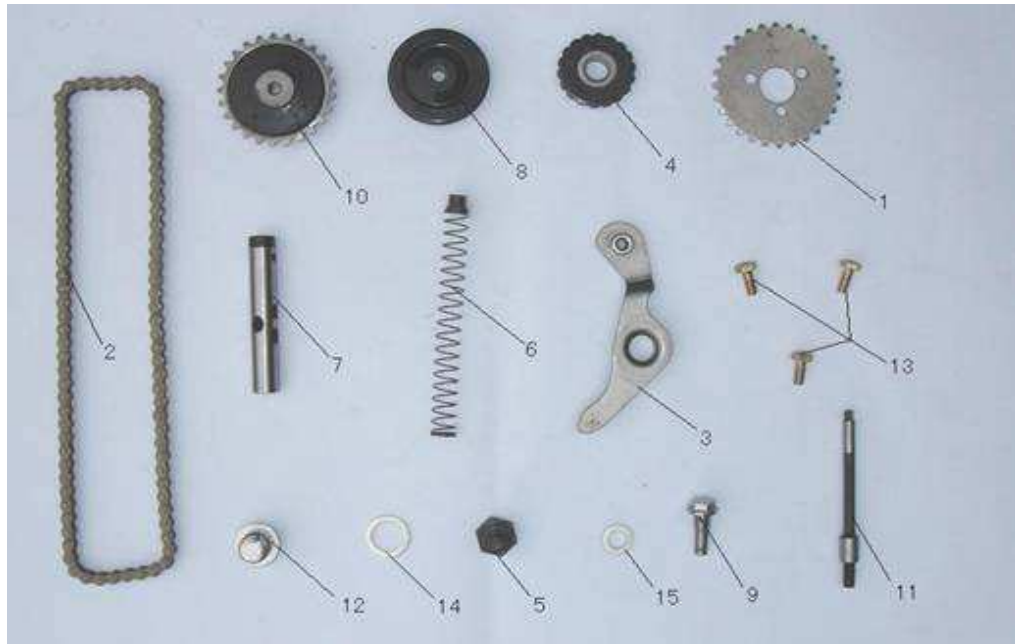

序	件 号	中文名称	英文名称	数量	单价	单价
NO.	Code name	Chinese	Description	Q' ty	¥	\$
1	1060203-1P50FMG	正时从动链轮28T	Chain Driven Wheel 28T	1		
2	GB6076-85	套筒滚子链条	Sleeve Chain	1		
3	1060420-1P50FMG	链条张紧臂组件	Chain Tensioning Arm Assemble	1		
4	1000068-1P50FMG	链条张紧轮	Chain Tensioning Wheel	1		
5	1060407-1P50FMG	链条张紧臂心轴	Chain Tensioning Arm mandrel	1		
6	1060404-1P50FMG	链条张紧杆弹簧	Chain Tensioning Staff Spring	1		
7	1060430-1P50FMG	链条张紧杆组件	Chain Tensioning Staff Assemble	1		
8	1060440-1P50FMG	链条导轮组件	Chain Idler Pulley Assemble	1		
9	1000066-1P50FMG	导向轮销轴	idler pulley Shaft	1		
10	1070300-1P50FMG	油泵传动链轮	Oil Pump Drive Chain Wheel	1		
11	1070305-1P50FMG	油泵链轮轴	Oil Pump Chain Wheel Shaft	1		
12	1060408-1P50FMG	张紧杆螺塞M14×1.25	Tensioning Staff Bolt M14×1.25	1		
13	GB5783-86	螺栓M5×12	Bolt M5×12	3		
14	GB97.2-85	垫圈14	Washer 14	1		
15	GB97.1-85	垫圈8	Washer 8	1		

## 气缸体组件(Cylinder Body Assemble)

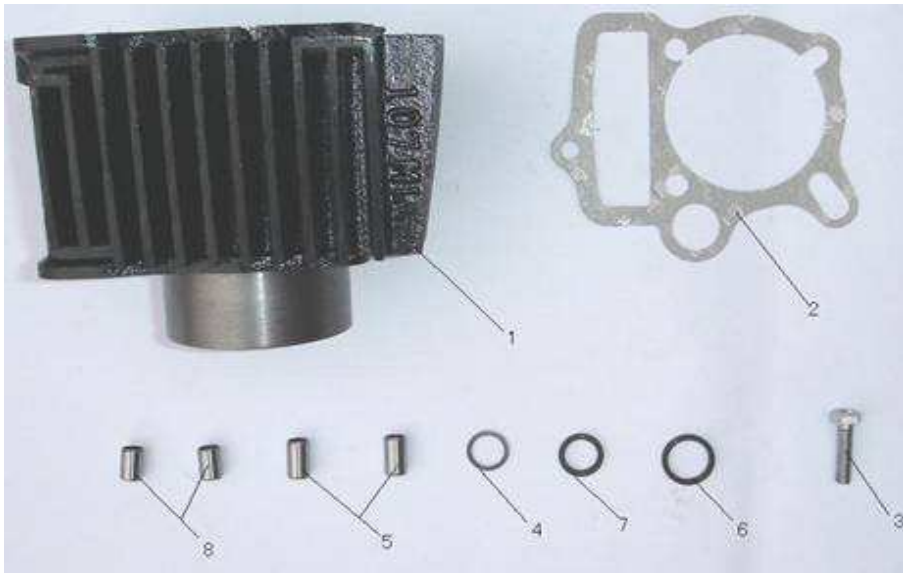

序 NO.	件 号 Code name	中文名称 Chinese	英文名称 Description	数量 Q' ty	单价 ¥	单价 \$
1	1020001-1P52FMH	气缸体	Cylinder Body	1		
2	1000024-1P50FMG	气缸体密封垫	Cylinder Body Washer	1		
3	GB5783-86	螺栓M6×23	Bolt M6×23	1		
4	GB97.2-85	垫圈6	Washer 6	1		
5	1000053-1P50FMG	定位销8×14	Position Plpe 8×14	2		
6	1000067-1P50FMG	矩形密封圈14.5×18.5×2.4	Rectangular Ring 14.5×18.5×2.4	1		
7	1000066-1P50FMG	矩形密封圈11.5×15.7×2.4	Rectangular Ring 11.5×15.7×2.4	1		
8	1000044-1P50FMG	定位销8×12	Position Plpe 8×12	2		

## 右曲轴箱盖组件 ( R. Crankcase Assembly)



序 NO.	件 号 Code name	中文名称 Chinese	英文名称 Description	数量 Q' ty	单价 ¥	单价 \$
1	1030120-1P52FMH	右曲轴箱盖	R.Crankcase Cover	1		
2	1110446-1P50FMG	右曲轴箱盖密封垫	R.Crankcase Cover Washer	1		
3	1000044-1P50FMG	定位销8×12	Position Pipe 8×12	2		
4	1110402-1P52FMH	离合器调节螺钉	Clutch Adjusted Screw	1		
5	1110447-1P52FMH	顶杆组合	Mandril Assembly	1		
6	GB3452. 1-92	O形密封圈7.5×1.8	O-Ring 7.5×1.8	1		
7	GB97. 1-85	垫圈8	Washer 8	1		
8	GB6177-85	螺母M8	Nut M8	1		
9	1030111-1P50FMG	机油标尺	Oil Staff Guage	1		
10	GB3452. 1-92	O形密封圈18×3	O-Ring 18×3	1		
11	1030107-1P52FMH	机油观察窗	Oil Observational Window	1		
12	GB5787-86	螺栓M6×40	Bolt M6×40	5		
13	GB5787-86	螺栓M6×80	Bolt M6×80	2		
14	GB5787-86	螺栓M6×65	Bolt M6×65	1		
15	1000038-1P50FMG	高压线固定夹	High Pressure Line Fixed Nip	1		
16	1000065-1P50FMG	右曲轴箱盖装饰盖	R.Crankcase Decorative Cover	1		
17	GB5787-86	螺栓M6×16	Bolt M6×16	2		



## 离合器总成(Clutch Assembly)

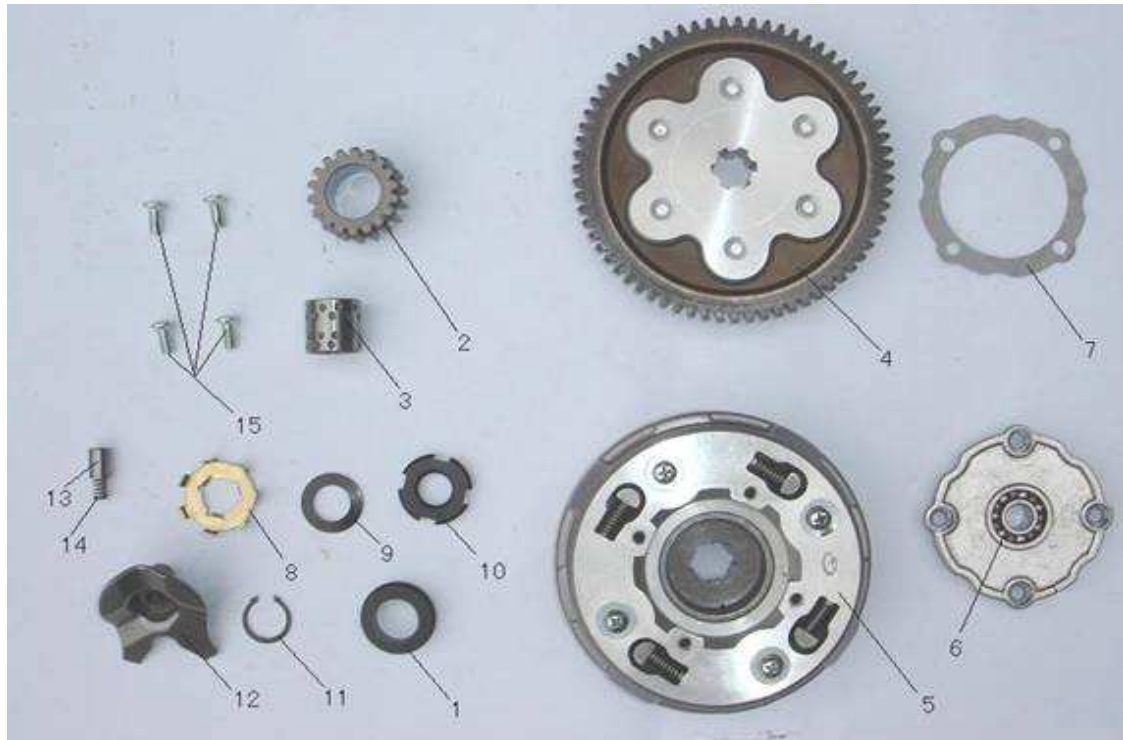

序 NO.	件 号 Code name	中文名称 Chinese	英文名称 Description	数量 Q' ty	单价 ¥	单价 \$
1	1130002-1P50FMG	主动齿轮垫套	Driver Wheel Washer	1		
2	1110003-1P52FMH-R	主动齿轮	Driver Wheel	1		
3	1130001-1P50FMG	主动齿轮轴套	Driver Wheel Axial Copy	1		
4	1130040-1P52FMH-R	从动齿轮组合	Driven Wheel Assembly	1		
5	1130000-1P52FMH-R	离合器组件	Clutch Assemble	1		
6	1130302-1P50FMG	离合器端盖带轴承6000	Clutch End Cover With Bearing 6000	1		
7	1130303-1P50FMG	离合器端盖密封垫	Clutch End Cover	1		
8	1130014-1P50FMG	锁紧垫圈	Locked Washer	1		
9	1130013-1P50FMG	碟形弹簧垫圈	Dishing Spring Washer	1		
10	1130012-1P50FMG	圆螺母	Circinal Nut	1		
11	1000052-1P50FMG	从动齿轮卡簧	Driven Wheel Spring	1		
12	1110470-1P50FMG	凸轮盘组件	Camplate Assemble	1		
13	1110448-1P50FMG	离合器通油管	Clutch Expedite Oil Pipe	1		
14	1110451-1P50FMG	离合器通油导管弹簧	Clutch Expedite Oil Pipe Spring	1		
15	GB819-85	螺钉M5×12	Screw M5×12	4		

## 机油泵组件(Oil Pump Assembly)

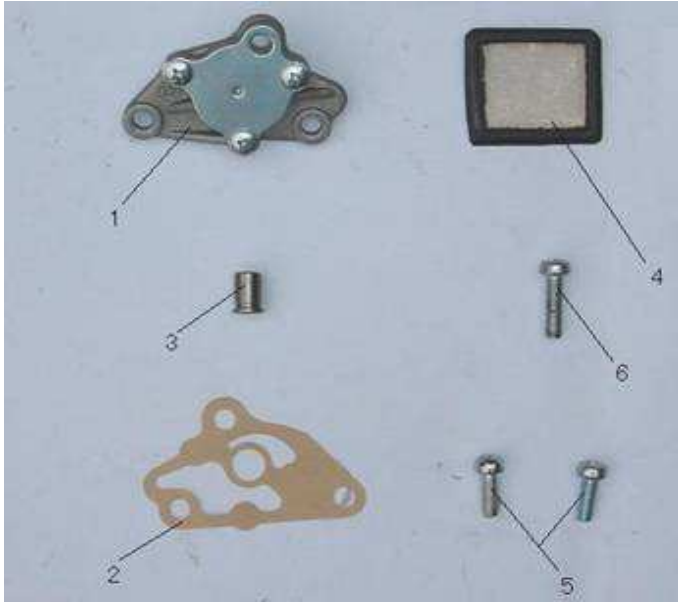

序 NO.	件 号 Code name	中文名称 Chinese	英文名称 Description	数量 Q'ty	单价 ¥	单价 \$
1	1070200-1P50FMG	油泵组件	Oil Pump Assembly	1		
2	1070207-1P50FMG	油泵体密封垫	Oil Pump Sealed Mat	1		
3	1070305-1P50FMG	油泵链轮轴套	Oil Pump chain wheel axial copy	1		
4	1080200-1P50FMG	机油过滤网组件	Oil Filter Net	1		
5	GB818-86	螺钉M6×16	Screw M6×16	2		
6	GB818-86	螺钉M6×22	Screw M6×22	1		

## 左曲轴箱盖组件(L. Crankcase Assembly Cover)

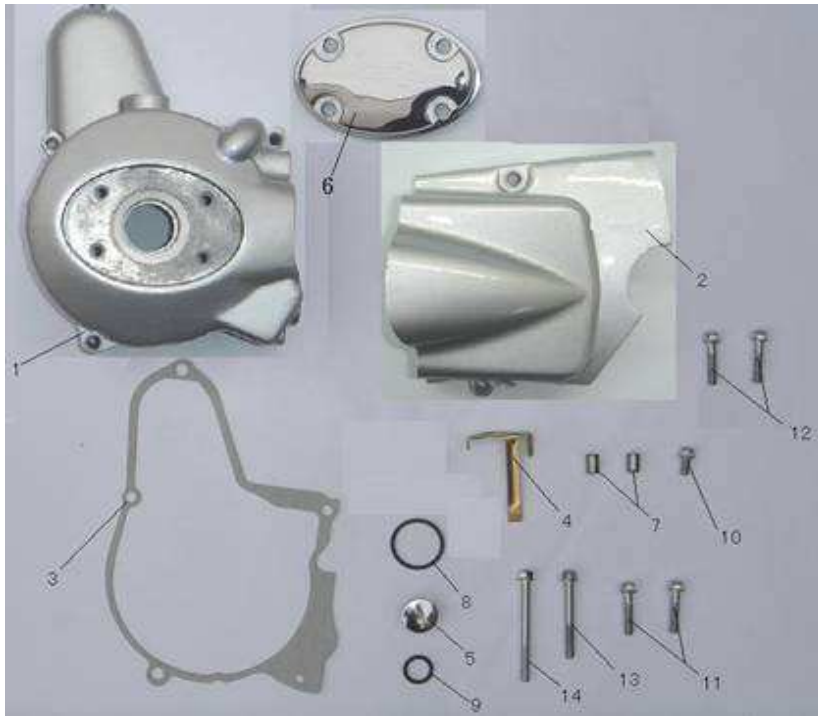

序 NO.	件 号 Code name	中文名称 Chinese	英文名称 Description	数量 Q' ty	单价 ¥	单价 \$
1	1030108-1P50FMG	左曲轴箱前盖	Frontal Cover of L.Crankcase	1		
2	1130108-1P50FMG-P	左曲轴箱后盖(030208-102)	Back Cover of L.Crankcase	1		
3	1030356-1P50FMG	左曲轴箱盖密封垫	L.Crankcase Washer	1		
4	1000031-1P50FMG	磁电机线夹	Magneto Clip	1		
5	1000057-1P50FMG	小视孔盖	Cover	1		
6	1000058-1P50FMG	小字牌盖	Plate Cover	1		
7	1000044-1P50FMG	定位销8×12	Position Plpe 8×12	2		
8	GB3452.1-92	O形密封圈27.4×2.4	O-Ring 27.4×2.4	1		
9	GB3452.1-92	O形密封圈13.8×2.5	O-Ring 13.8×2.5	1		
10	GB5787-86	螺栓M6×16	Bolt M6×16	1		
11	GB5787-86	螺栓M6×25	Bolt M6×25	2		
12	GB5787-86	螺栓M6×32	Bolt M6×32	2		
13	GB5787-86	螺栓M6×50	Bolt M6×50	1		
14	GB5787-86	螺栓M6×70	Bolt M6×70	1		

## 磁电机总成 (Magneto Assembly)



序 NO.	件 号 Code name	中文名称 Chinese	英文名称 Description	数量 Q' ty	单价	
					¥	\$
1	1151320-1P52FMH	转子组合	Rotor Assembly	1		
2	1151330-1P52FMH	定子组合	Stator Assembly	1		
3	GB5787-86	螺栓M6×16	Bolt M6×16	2		
4	GB6177-85	螺母M10	Nut M10	1		
5		触发器压线板	Flip-flop tensiondisc	1		
6	GB819-86	螺栓M5×6	Bolt M5×6	1		
7	GB819-86	螺栓M5×20	Bolt M5×20	2		

电起动组件(Electrical Starting Transmission Assembly)

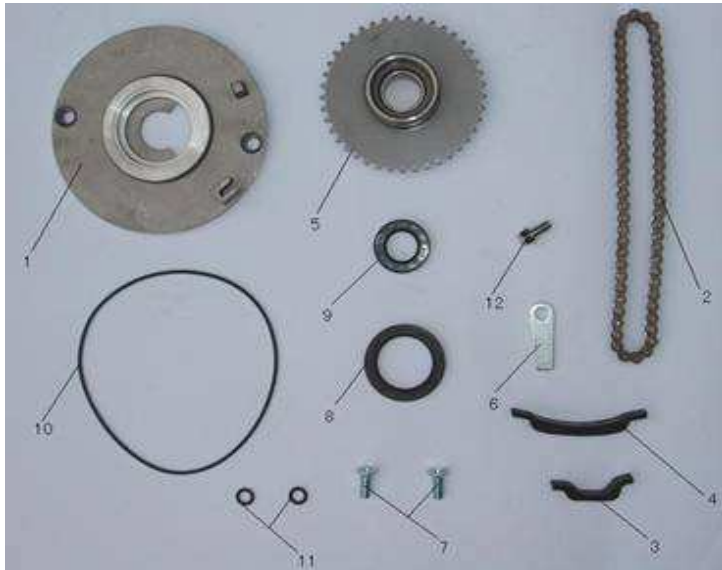

序 NO.	件 号 Code name	中文名称 Chinese	英文名称 Description	数量 Q'ty	单价	
					¥	\$
1	1030348-1P50FMG	隔油盘	Divide oil plate	1		
2	1140010-1P50FMG	起动链条	Staring Chain	1		
3	1030354-1P50FMG	链条导向板	Chain oriented Plate	1		
4	1030353-1P50FMG	链条张紧板	Chain Tensioning Plate	1		
5	1151340-1P50FMG	起动链轮组合	Staring chain wheel Assembly	1		
6	1030355-1P50FMG	链轮压板	Chain Wheel Press Board	1		
7	GB819-85	螺钉M6×16	Screw M6×16	2		
8	1000056-1P50FMG	隔油盘油封30×42×4.5	Seal of Divide oil plate	1		
9	1000055-1P50FMG	链轮油封18.9×30×5	Chain Wheel Oil Seal	1		
10	GB3452.1-92	O形密封圈107×2	O-Ring 107×2	1		
11	GB3452.1-92	O形密封圈5.8×1.9	O-Ring 5.8×1.9	2		
12	GB5787-86	螺栓M6×12	Bolt M6×12	1		

起动电机总成 (Staring Moto Assembly)



序 NO.	件 号	中文名称	英文名称	数量 Q' ty	单价	
	Code name	Chinese	Description		¥	\$
1	1151400-1P50FMG	起动电机总成	Staring Motor Assembly	1		
2	GB5787-86	螺栓M6×50	Bolt M6×50	3		

## 曲轴箱组件(Crankcase Assembly)



序 NO.	件 号 Code name	中文名称 Chinese	英文名称 Description	数量 Q' ty	单价	
					¥	\$
1	1030210-1P52FMH-R	右曲轴箱体	R.Crankcase Body	1		
2	1030002-1P50FMG	曲轴箱密封垫	Crankcase Seal Washer	1		
3	1030310-1P52FMH-R	左曲轴箱体	L.Crankcase Body	1		
4	1030344-1P50FMG	通气管	Joint	1		
5	1000019-1P50FMG	溢流管夹	Overfilled Pipe Nip	1		
6	1000021-1P50FMG	废气管夹	Waste Pipe Nip	1		
7	1020005-1P50FMG	气缸螺栓A	Bolt A	2		
8	1020006-1P50FMG	气缸螺栓B	Bolt B	2		
9	GB97.1-85	垫圈12	Washer 12	1		
10	1000043-1P50FMG	定位销10×14	Position Pipe 10X14	2		
11	1030203-1P50FMG	放油螺塞M12×1.5	Releasing bolt M12×1.5	1		
12	1-1P50FMG	废气管卡箍	Waste Pipe Clip	1		
13	GB5787-86	螺栓M6×50	Bolt M6X50	1		
14	GB5787-86	螺栓M6×60	Bolt M6X60	2		
15	GB5787-86	螺栓M6×65	Bolt M6X65	4		
16	1000069-1P50FMG	换档臂油封11.6×24×10	Shift Arm Oil Seal	1		

## 曲轴连杆、活塞组合 (CRANKSHAFT CONNECTING ROD PISTON)

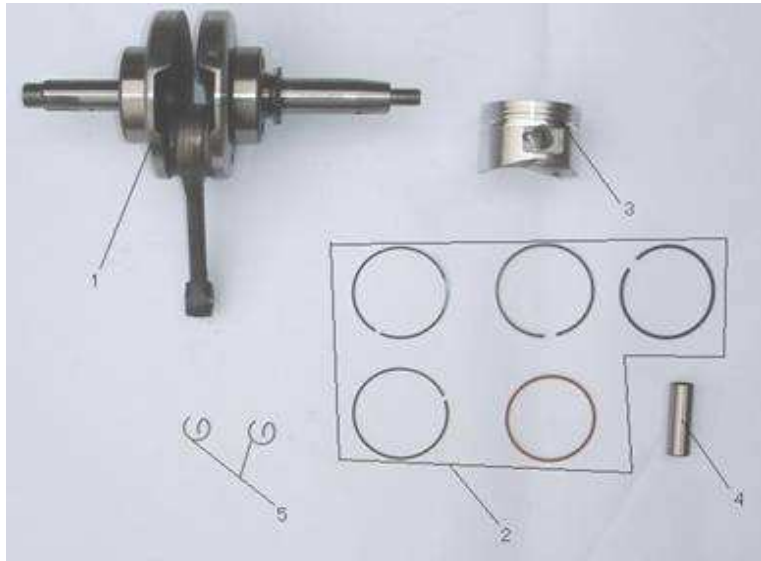

序 NO.	件 号 Code name	中文名称 Chinese	英文名称 Description	数量 Q' ty	单价	
					¥	\$
1	1040000-1P50FMG	曲轴连杆总成	Crank Connecting Rod Assembly	1		
2	1050100-1P52FMH	活塞环组	Piston Ring Assembly	1		
3	1050001-1P52FMH	活塞	Piston	1		
4	1050002-1P52FMH	活塞销	Piston Pin	1		
5	1050003-1P50FMG	活塞销挡圈	Circlip Pinton	2		



传动机构 (TRANSMISSION GEAR)

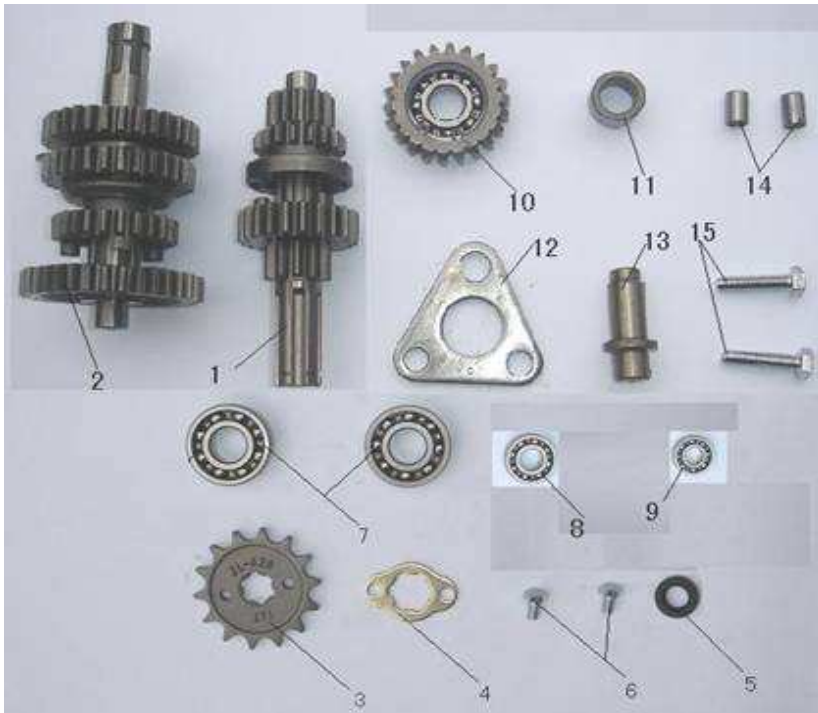

序 NO.	件号 Code name	中文名称 Chinese	英文名称 Description	数量 Q'ty	单价 ¥ \$	
1	1130030-1P52FMH-R	主轴组件	Principal Axis Assembly	1		
2	1130010-1P52FMH-R	副轴组件	Countershaft Assembly	1		
3	1130023-1P50FMG	主动链轮	Driver Chain Wheel	1		
4	1130024-1P50FMG	主动链轮固定板	Driver Chain Wheel Retaining Plate	1		
5	1000049-1P50FMG	副轴油封17×29×5	Countershaft Oil Seal 17×29×5	1		
6	GB5783-86	螺栓M6×8	Bolt M6X8	2		
7	GB276-94	滚动轴承6203	Roll Bearing 6203	2		
8	GB289-64	滚动轴承6201	Roll Bearing 6201	1		
9	GB289-64	滚动轴承6001	Roll Bearing 6001	1		
10	1130070-1P52FMH-R	倒档惰轮	Reverse Idler Wheel	1		
11	1130067-1P52FMH-R	倒档惰轮轴套	Reverse Idler Wheel axis sheath	1		
12	1130068-1P52FMH-R	倒档惰轮轴压板	Reverse Idler Wheel axis Press Board	1		
13	1130069-1P52FMH-R	倒档惰轮轴	Reverse Idler Wheel axis	1		
14	1130010-1P52FMH-R	定位销 φ8×14	Locating Pin 8×14	2		
15	GB5783-86	螺栓M6×25	Bolt M6×25	2		

## 变速机构 (SHIFT GEAR)



序	件号	中文名称	英文名称	数量	单价	
NO.	Code name	Chinese	Description	Q'ty	¥	\$
1	1130200-1P52FMH-R	变速鼓总成	Transmission Drum Assembly	1		
2	1130400-1P50FMG	变速鼓定位板	Transmission Drum Position board	1		
3	1000036-1P50FMG	定位板复位弹簧	Position Board Reposition Spring	1		
4	1130500-1P52FMH	换档臂组件	Shift Arm Assembly	1		
5	1030202-1P50FMG	定位螺栓	Position Bolt	1		
6	1151500-1P52FMH-R	档显器组件	Gear showing parts	1		
7	1000007-1P50FMG	档显器压板	Gear showing plate	1		
8	GB5787-86	螺栓M6×12	Bolt M6×12	1		
9	1000035-1P50FMG	定位板螺栓	Position board Bolt	1		

## 车架 (Chassis)

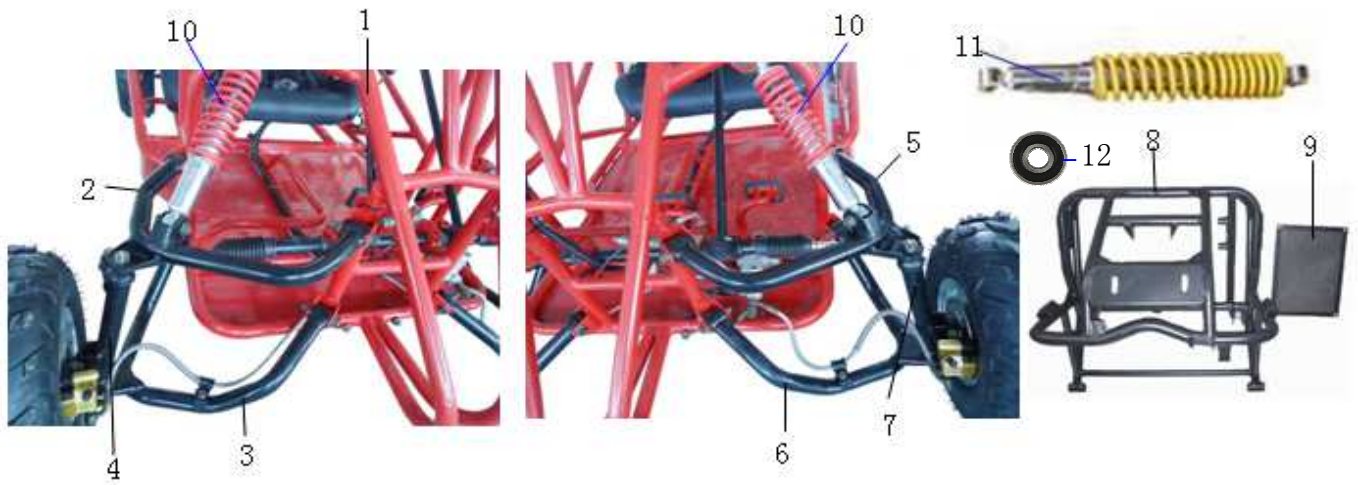

序 NO.	件 号 Code name	中文名称 Chinese	英文名称 Description	数量 单价		
				Q' ty	¥	\$
1	02010804-125GKB	车架	Frame	1		
2	02010806	上摇臂组件右	Upper Rocker Arm (R.)	1		
3	02010808	下摇臂组件右	Lower Rocker Arm(R.)	1		
4	02030169	前转角右	Front steeling (R.)	1		
5	02010805	上摇臂组件左	Upper Rocker Arm (L.)	1		
6	02010807	下摇臂组件左	Lower Rocker Arm (L.)	1		
7	02030168	前转角左	Front steeling (L.)	1		
8	02010814	后桥托架总成	Rear axle of bracket Assy	1		
9	02010084	后装饰网	Rear Net Protector	1		
10	07010079	前减震L:270	Front Shock absorber L: 270	2		
11	07010010	后减震L:350	Rear Shock absorber L: 350	2		
12	12030021	轴承6903	Bearing 6903	2		

### 车架 2 (Chassis 2)

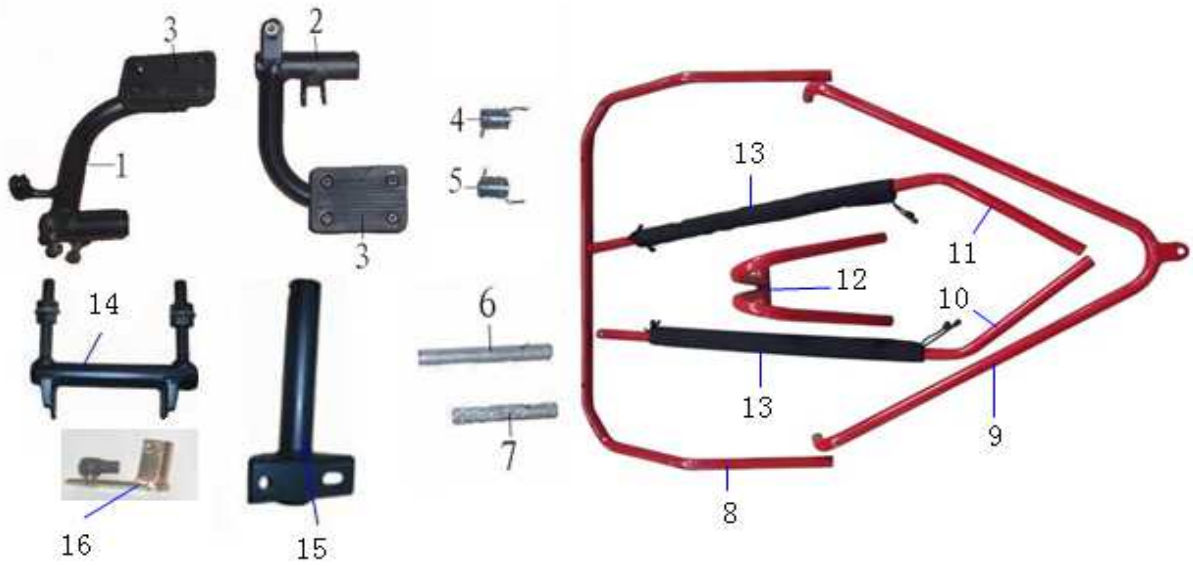

序 NO.	件 号 Code name	中文名称 Chinese	英文名称 Description	数量 Q' ty	单价	
					¥	\$
1	02010815	油门踏板组件	Accelerator Pedal	1		
2	02010816	刹车踏板组件	Brake Pedal	1		
3	06990015	脚刹踏板防滑套	Brake Pedal Shoe	2		
4	07020025	油门踏板扭簧	Accelerator Pedal Torsional	1		
5	07020026	脚刹踏板扭簧	Brake Pedal Torsional Spring	1		
6	02010326	刹车杆内衬套	Brake Rod neck Bush	1		
7	02010324	油门杆内衬套	Accelerator Rod neck Bush	1		
8	02010812	棚架中	Middle Roof	1		
9	02010811	棚架后	Top Roof(Rear)	1		
10	02010809	棚架左	Top Roof(L.)	1		
11	02010809	棚架右	Top Roof(R.)	1		
12	02010813	前护杠	Front Bumper	1		
13	03990005	棚架帆布	Roof Canvas	2		
14	02010077	调节轴组件	Adjusting shaft	1		
15	02010078	消声器固定支架	Muffler Fixing plate	1		
16	02010817	变档摇臂组件	Shift Rocker Arm Assy	1		

### 车架 3 (Chassis 3)



序	件 号	中文名称	英文名称	数量	单价	
NO.	Code name	Chinese	Description	Q' ty	¥	\$
1	05030004	油箱	Fuel tank	1		
2	190012	传感器	Sensor	1		
3	190013	油箱盖	Fuel tank cap	1		
4	10060003	油箱开关	Fuel tank switch	1		
5	01040004	空滤器	Ail filter	1		
6	03030034	仪表板	Instrument board	1		
7	10010010	大灯开关	Switch headlight	1		
8	10010012	启动开关	Switch electric start	1		
9	10010011	熄火开关	Kill switch	1		
10	10080009	电门锁 (插口式)	Lock	1		
11	01990001	二次补气装置 (简易)	Twice adding air	1		
12	01050006	消声器	Muffler	1		
13	01990020	石棉垫	Asbestos mat	1		
14	02010062	变档杆组件	shift-level Assy	1		
15	06990017	手刹杆球头	Hand brake ball joint	1		
16	02010061	六角螺栓M10*32.5	Hexagon bolt M10*32.5	1		
17	06990063	堵头	End Cap	1		
18	02010830	手刹器	Handbrake	1		
19	02010818	拉线固定架	Line Fixed Mount	1		

## 后桥轴 (Rear Axle)

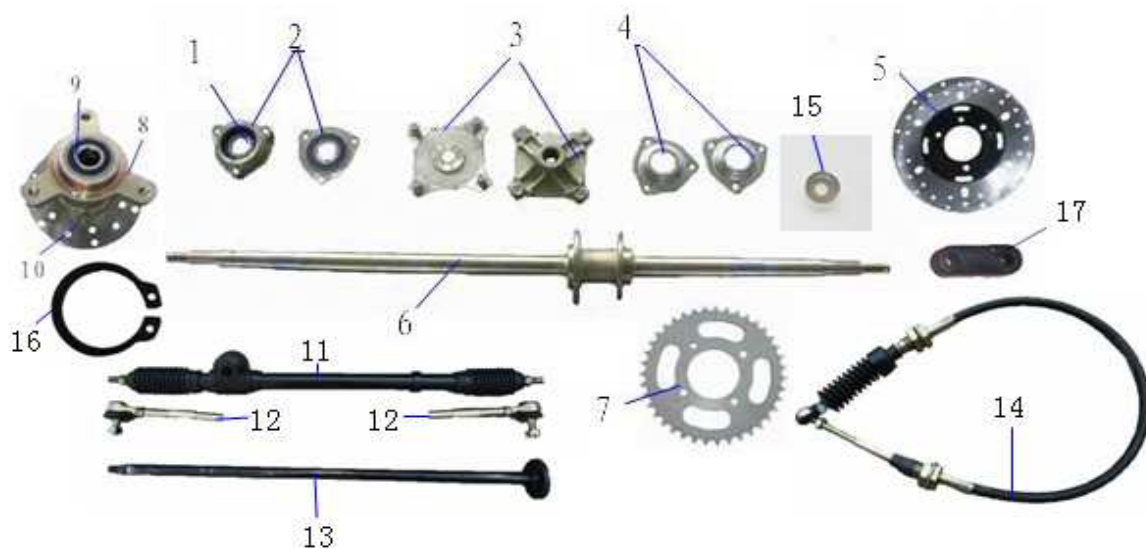

序	件号	中文名称	英文名称	数量	单价	
NO.	Code name	Chinese	Description	Q'ty	¥	\$
1	12030020	轴承6205	Bearing 6205	2		
2	02040012	轴承座组件	Bearing Seat Assy	2		
3	02040015	轮毂座总成	Wheel Hub Seat	2		
4	02040009	轴承座防尘盖	Bearing Seat Dust Cap	2		
5	04020004	后碟刹盘	Rear brake disc	1		
6	02040014	后桥轴总成	Rear axle Assy	1		
7	02040015	链盘 (牙盘43)	Sprocket	1		
8	02040018	前轮毂座组件	Front wheel hub seat	2		
9	12030013	轴承6202	Bearing 6202	4		
10	04020002	前碟刹盘105mm*6孔	Front brake disc 105mm	2		
11	02030173	方向机	Redirector Assy	1		
12	02030172	转向拉杆 (带球头)	Steering linkage(with Ball)	2		
13	02030171	方向盘固定柱	Steering wheel body axis	1		
14	08020151	换档线	Shift Line	1		
15	12020007	轮毂全铁防尘盖16*47*6	Iron dust cap 16*47*6	2		
16	12050003	轴用卡簧17	Clamp Spring 17	2		
17	02030170	方向机压板	Redirector Assy Press Plate	2		

## 轮胎及刹车系统 (Wheels and Brake system)



序	件号	中文名称	英文名称	数量	单价	
NO.	Code name	Chinese	Description	Q'ty	¥	\$
1	05020001	安全带 (简易款)	Safety Belt	2		
2	01020008	整流器	Rectifier	1		
3	01020010	高压包	Ignition coil	1		
4	01020007	点火器 (限速)	Igniter	1		
5	01020021	继电器	Relay	1		
6		气门嘴	Cycle valve	4		
7	06010004	轮胎145/70-6	Tyre 145/70-6	2		
8	06010005	轮胎16*8-7	Tyre 16*8-7	2		
9	12020001	轮毂防尘盖 (小)	Dust Cover(S)	4		
10	06030002	汽油管4.5/8.5	Oil tube 4.5/8.5	40		
11	12010007	油管夹8.5	Oil tube Clamp 8.5	4		
12	06990001	二级过滤器	Twice air filter	1		
13	04010056	碟刹总成	Disc Brake Assy	1		
14	02040004	钢圈6*4.5 (前)	Iron Rim 6*4.5(F.)	2		
15	02040013	钢圈7*5.0 (后)	Iron Rim 7*5.0(R.)	2		
16	05010004	坐垫 (连双座)	Seat	1		
17	12990004	碟刹管线夹	Pipeline Clamp	6		

## 电器系统 (Electrical system)



序 NO.	件号 Code name	中文名称 Chinese	英文名称 Description	数量 单价		
				Q'ty	¥	\$
1	08010051	电缆线	Master cable	1		
2	02030018	方向盘(带盖) 265	Steering wheel 265	1		
3	02010057	电瓶支架	Battery stand	1		
4	09030004	尾灯	Taillight	1		
5	09040004	三星装饰灯	Fog light	2		
6	08020150	油门线	accelerator cables	1		
7	10990002	电瓶YTX5A-BS	battery YTX5A-BS	1		
8	02030171	方向盘固定柱	Steering wheel body axis	1		
9	07020010	刹车开关拉簧	Braking switch extension spring	1		
10	02040116	链条428H-58	Chain 428H-58	1		
11	06990004	蓬架橡塑外套25	The loose frame oak models the	2		
12	03990053	网布	Net cover	1		
13	06020082	整流器橡胶垫	Washer	4		
14	12020004	摇臂橡胶防尘盖M10	Dust Cover M10	4		



随车工具包 (Tool Kit)



序	件 号	中文名称	英文名称	数量	单 价	
NO.	Code name	Chinese	Description	Q' ty	¥	\$
1	16010005	12-14开口扳手	Open spanner(12-14)	1		
2	16010004	8-10开口扳手	Open spanner(8-10)	1		
3	16010006	双头螺丝刀	Dual-purpose screwdriver	1		
4	16010007	16对边火花塞套筒	Spark plug box spanner(S=16)	1		
5	16010002	6mm内六角扳手	Socket head screw wrench(6mm)	1		
6	16010001	5mm内六角扳手	Socket head screw wrench(5mm)	1		